

FOR CONTINUATION,
 SEE DRAWING NO. 0008

FOR CONTINUATION,
 SEE DRAWING NO. 0006

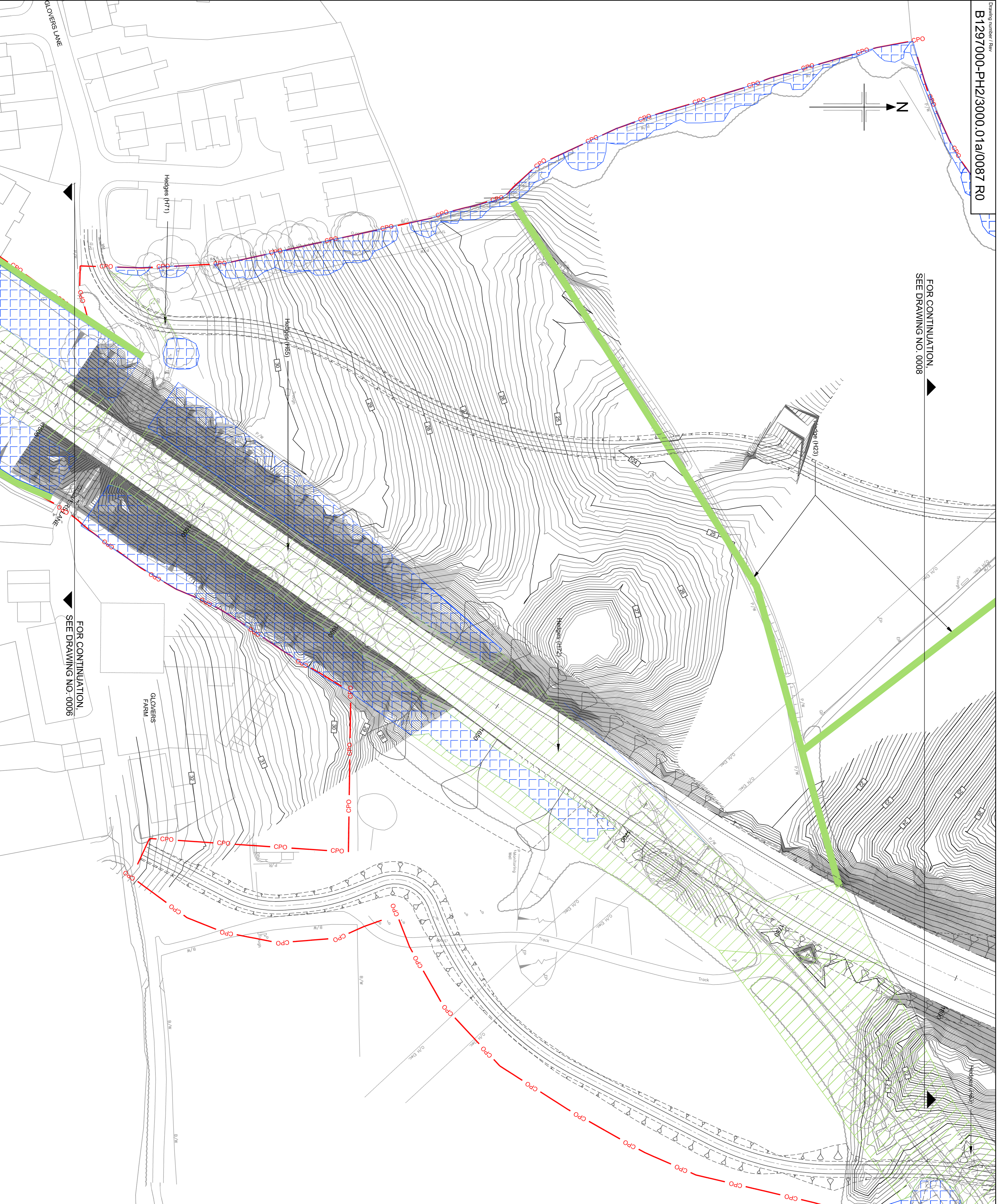

NOTES
 1. Refer to drawing number B1297000/0200.01b/0001 to 0015 for Tree Survey - December 2012 Root Protection Zones.

KEY
 [Blue hatched box] Area of Hedges, trees, fence/lines and scrub
 [Green hatched box] Hedge rows and fence lines
 [Green line] Area of managed vegetation to be retained shall be protected by temporary 2m high steel tube and wire mesh fencing in accordance with BS 5831. Areas of managed vegetation to be removed shall be protected by temporary construction works may be protected by timber post and three wire fence.

SAFETY, HEALTH AND ENVIRONMENTAL INFORMATION
 In addition to the hazards/risks normally associated with the types of work detailed on this drawing, note the following:

CONSTRUCTION
MAINTENANCE / CLEANING
DECOMMISSIONING / DEMOLITION

It is assumed that all works will be carried out by a competent contractor working, where appropriate, to an approved method statement.

Reproduction from the Ordnance Survey Map with the permission of the controller of Her Majesty's Stationery Office Crown copyright reserved Licence No. AL 100017326

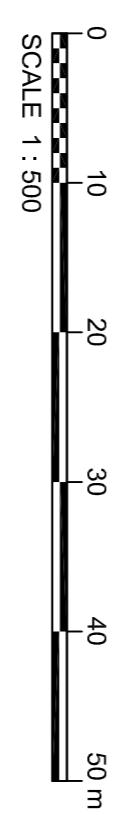

Rev	Rev. Date	INITIAL ISSUE	ASC	RIS	SSG	RBD
R0	23/01/2013	Purpose of revision				

Client: **JACOBS**
 Simpson House, 6 Cherry Orchard Road, Croydon, Surrey, CR9 6BE
 Tel: +44 (0)2038 882 872 Fax: +44 (0) 208 881 2489
 www.jacobs.com

Employer: **HOCHTIEF TRaylor WOODROW**
 4th Floor, 100 Broad Street, Birmingham, B2 4DB
 www.hochtief-traylor-woodrow.com

BEXHILL TO HASTINGS LINK ROAD
PLANNING CONDITION 14
VEGETATION CLEARANCE
SHEET 7 OF 35

Drawing title: **ISSUE FOR REVIEW**

Drawing status: **DO NOT SCALE**

Scale: 1:500 @ A1

Jacobs No.: B1297000-PH2

Client No.: B1297000-PH2

Drawing number: **B1297000-PH2/3000.01a/0087 R0**

Rev: R0

This drawing is not to be used in whole or part other than for the intended purpose and project as defined on this drawing. Refer to the contract for full terms and conditions.